

SpaceLogic Sensors

Duct Temperature Sensors

STD500 Series – NTC 10 kΩ for Continuum



Product Description

The STD500 temperature sensor is intended for air duct mounting. The sensor element is an NTC 10 kΩ for Continuum products. The STD500 housing is equipped with an M16x1.5 cable fitting and an M16/M20 adapter for conduit.

Accuracy

At Temperature	Accuracy
-25 °C (-13 °F)	±0.5 °C (±0.9 °F)
0 °C (32 °F)	±0.2 °C (±0.4 °F)
25 °C (77 °F)	±0.2 °C (±0.4 °F)
50 °C (122 °F)	±0.2 °C (±0.4 °F)
70 °C (158 °F)	±0.2 °C (±0.4 °F)
100 °C (212 °F)	±0.5 °C (±0.9 °F)

Specifications

Sensor element	NTC 10 kΩ at +25 °C (77 °F)
Time Constants	
Air velocity 1.5 m/s	72 sec. (approx.)
Air velocity 3.0 m/s	52 sec. (approx.)
Material	
Immersion tube	Stainless steel
Connection box	Polyamid plastic
Mounting flange	Black plastic
Enclosure rating	IP 65
Measurement current	<2 mW
Temperatures	
Ambient	-40 °C (-40 °F) min. 130 °C (266 °F) max.
Operating	-40 °C (-40 °F) min. 150 °C (302 °F) max.
Operating humidity range	0 to 95% (non-condensing)
Standards	
EMC	EN 61326-1, EN 61326-2-3

Available Products

Part Number	Model Number	Probe		NL		Weight (Item)		Weight (PG)		Weight (Flange)	
		mm	in.	mm	in.	g	lb.	g	lb.	g	lb.
5123074010	STD500-150	150	5.91	163	6.42	122.75	0.27	11.70	0.03	17.42	0.04
5123076010	STD500-200	200	7.87	213	8.39	122.74	0.27	11.70	0.03	17.42	0.04
5123078010	STD500-250	250	9.84	263	10.35	126.16	0.28	11.70	0.03	17.42	0.04
5123080010	STD500-300	300	11.81	313	12.32	128.92	0.28	11.70	0.03	17.42	0.04
5123082010	STD500-400	400	15.75	413	16.26	134.64	0.30	11.70	0.03	17.42	0.04

North America (USA): +1 888 444 1311
 Europe, Middle East & Africa (Sweden): +46 10 478 2000
 Asia Pacific (Singapore): +65 6484 7877
 product.support@schneider-electric.com
 www.schneider-electric.com

Schneider
Electric

Dimensions mm (in.)

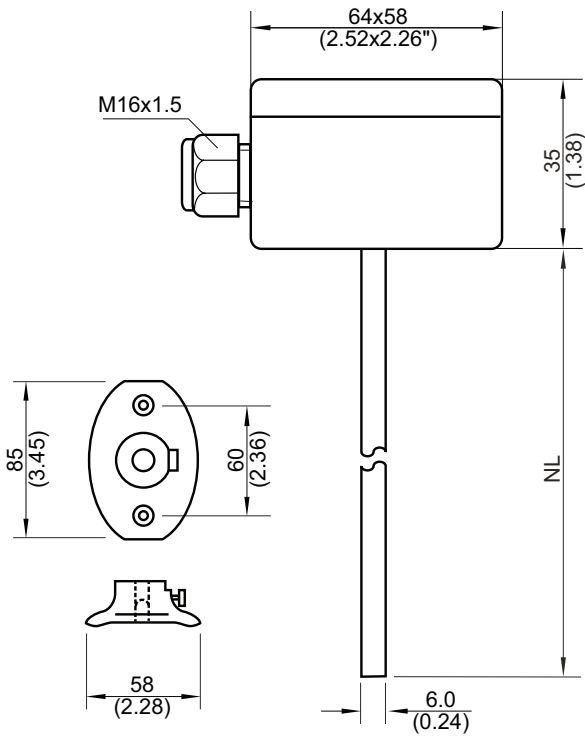

Wiring

